

Constant Wattage Autotransformer Ballasts with Lead Wires for ANSI Type Metal Halide Lamps



Cross section: 4.25" x 4.17"

Vacuum-pressure impregnated core and coil

Low noise

Closed end caps

Compatible mounting hole spacing

All holes cleared for #10 thru-bolts

Power factor ≥ 0.95

Acc. to EN 61347/60923

Capacitor included

Class H insulation system (180°)

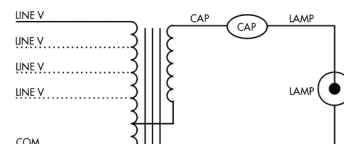
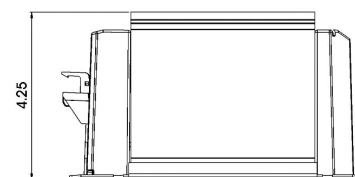
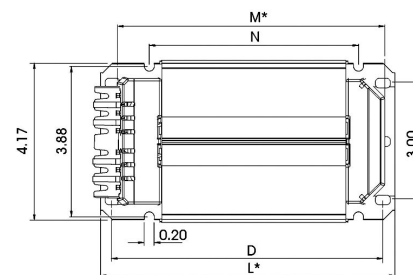

L* Maximum overall length using ELTAM's standard Flexi-Mount base plate.

Reduced Size (-RS) base plate is available on request. See dimension M.

M* Minimum ballast length dimension using RS base plate. Specify -RS base plate when ordering.

The capacitor is essential for circuit operation

MH Lamp			Ballast 120/208/240/277V - 60Hz*							Capacitor	Line		UL Benchtop
Type	Rated Power	Rated Current	Type	Weight	Dimensions				OCV	60 Hz. Operator	Power	Current	Temp. Rise Code
ANSI CODE	W	A		lbs.	L	D	N	M	V	$\mu\text{F} \pm 2.5\% / \text{V}$	W	@120/208/240/277V	
M57	175	1.5	MCWA 175	7.9	5.98	5.38	3.50	3.98	302	10 / 450	200	1.73 / 1.00 / 0.86 / 0.75	A / A / A / A
M58	250	2.15	MCWA 250	11.0	5.98	5.38	3.50	4.57	305	15 / 450	288	2.50 / 1.45 / 1.25 / 1.10	A / A / A / A
M59	400	3.25	MCWA 400	15.6	5.98	5.38	4.38	5.36	305	24 / 450	450	3.84 / 2.22 / 1.92 / 1.67	B / B / B / B
M47	1000	4.10	MCWA 1000	23.8	7.71	6.81	5.37	7.13	380	26 / 450	1060	9.10 / 5.20 / 4.50 / 3.90	A / A / A / A
M48	1500	6.20	MCWA 1500	27.6	8.50	7.72	5.94	7.72	395	38 / 500	1585	13.6 / 8.00 / 6.90 / 6.00	C / C / C / C

* Other Voltages and Frequencies Available

Specifications are provided for information only and are subject to change without notice.

www.eltam-eh.com