

Constant Wattage Autotransformer Ballasts with Lead Wires for ANSI Type Pulse-Start Metal Halide lamps



Cross section: 4.25" x 4.17"

Vacuum-pressure impregnated core and coil

Low noise

Closed end caps

Compatible mounting hole spacing

All holes cleared for #10 thru-bolts

Power factor ≥ 0.95

Acc. to EN 61347/60923

Capacitor included

Class H insulation system (180°)

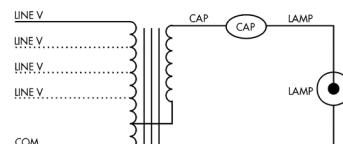
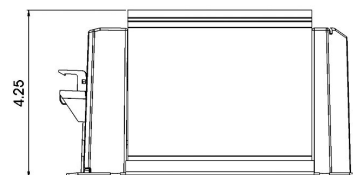
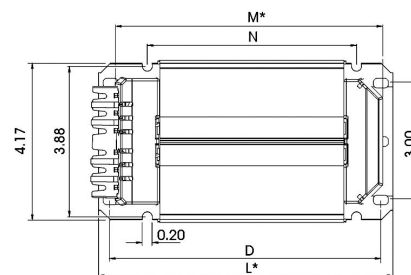

L* Maximum overall length using ELTAM's standard Flexi-Mount base plate.

Reduced Size (-RS) base plate is available on request. See dimension M.

M* Minimum ballast length dimension using RS base plate. Specify -RS base plate when ordering.

The capacitor is essential for circuit operation

MH Lamp			Ballast 120/208/240/277V - 60Hz*							Capacitor	Line		UL Benchtop	Ign.
Type	Rated Power	Rated Current	Type	Weight	Dimensions				OCV	60 Hz. Operator	Power	Current	Temp. Rise Code	
ANSI CODE	W	A		lbs.	L	D	N	M	V	$\mu F \pm 2.5\% / V$	W	@120/208/240/277V		
M136	200	1.60	PCWA 200	7.9	5.98	5.38	3.50	3.98	240	16 / 300	230	1.95 / 1.13 / 0.98 / 0.85	A / A / A / A	ES-CWA 400
M138/153	250	2.10	PCWA 250	11.0	5.98	5.38	3.50	4.57	300	15 / 450	290	2.45 / 1.41 / 1.22 / 1.06	A / A / A / A	ES-CWA 400
M132/154	3 20	2.65	PCWA 320	11.0	5.98	5.38	3.50	4.57	265	22 / 350	360	3.10 / 1.80 / 3.10 / 1.80 /	B / A / A / A	ES-CWA 400
M131	350	2.80	PCWA 350	11.0	5.98	5.38	3.50	4.57	260	24 / 450	395	3.35 / 1.95 / 1.70 / 1.45	B / B / B / B	ES-CWA 400
M128/135/155	400	3.25	PCWA 400	15.6	5.98	5.38	4.38	5.36	285	24 / 450	450	3.85 / 2.20 / 1.90 / 1.65	B / B / A / A	ES-CWA 400

* Other Voltages and Frequencies Available

Specifications are provided for information only and are subject to change without notice.

www.eltam-eh.com