

## Constant Wattage Autotransformer Ballasts with Lead Wires for ANSI Type HPS Lamps

Cross section: 4.25" x 4.17"

Vacuum-pressure impregnated core and coil

Low noise

Closed end caps

Compatible mounting hole spacing

All holes cleared for #10 thru-bolts

Power factor  $\geq 0.95$

Acc. to EN 61347/60923

Capacitor included

Class H insulation system (180°)

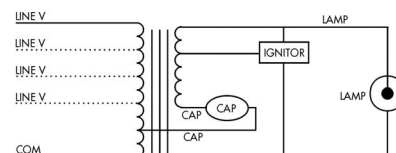
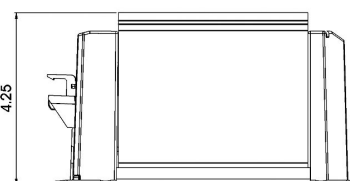
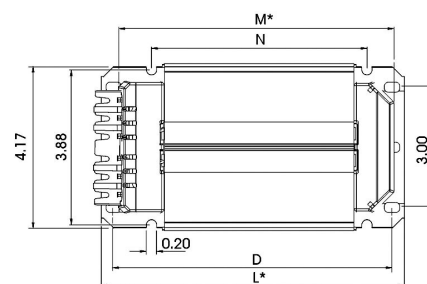

L\* Maximum overall length using ELTAM's standard Flexi-Mount base plate.

Reduced Size (-RS) base plate is available on request. See dimension M.

M\* Minimum ballast length dimension using RS base plate. Specify -RS base plate when ordering.

The capacitor and ignitor are essential for circuit operation

HPS Lamp			Ballast 120/208/240/277V - 60Hz*							Capacitor	Ignitor	Line		UL Benchtop Temp. Rise Code
Type	Rated Power	Rated Current	Type	Weight	Dimensions				OCV	60 Hz. Operator		Power	Current	
ANSI CODE	W	A		lbs.	L	D	N	M	V	$\mu\text{F} \pm 2.5\% / \text{V}$		W	@120/208/ 240/277V	
S50	250	3.0	SCWA 250	11.0	5.98	5.38	3.50	4.57	195	35 / 300	ES-CWA 400	295	2.60 / 1.50 / 1.30 / 1.15	C/A/A/A
S51	400	4.6	SCWA 400	15.6	5.98	5.38	4.38	5.36	190	55 / 300	ES-CWA 400	450	4.00 / 2.30 / 2.00 / 1.70	D/C/C/C
S106	600	6.2	SCWA 600	23.8	7.71	6.81	5.37	7.13	200	72 / 300	ES-CWA 400	665	6.00 / 3.50 / 3.00 / 2.60	C/A/A/A
S52	1000	4.7	SCWA 1000	27.6	8.50	7.72	5.94	7.72	410	30 / 500	ES-CWA 1000	1090	9.50 / 5.40 / 4.70 / 4.10/155	E/D/D/D

\* Other Voltages and Frequencies Available